



-  Dielectric Grease (92-823509-1)
-  Loctite PST Pipe Sealant (92-809822)



9149

Parts List

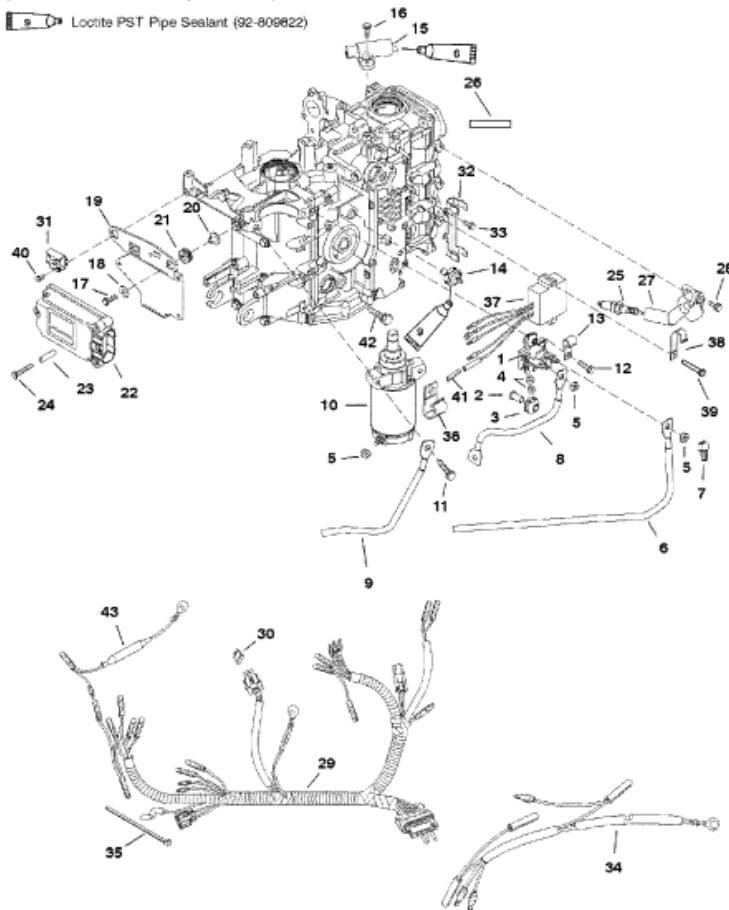
Ref	Class	Part	Description	Qty	Comment	Footnote
1	89	850187T 1	SOLENOID ASSEMBLY	1	(ELECTRIC)	
2	23	818968	BUSHING	2	(ELECTRIC)	
3	25	818967	GROMMET	2	(ELECTRIC)	
4	11	26419	NUT, (#8-32)	2	(ELECTRIC)	
5	11	94330	NUT, (.250-20)	3	(ELECTRIC)	
6	84	88439A 9	BATTERY CABLE, Positive	1	(ELECTRIC)	
7	85	79695	BOOT, Insulator (Black)	1	(ELECTRIC)	
8	84	93388A12	CABLE	1	(ELECTRIC)	
9	84	88439A 4	BATTERY CABLE, Negative	1	(ELECTRIC)	
10	50	859170T 1	STARTER MOTOR	1	(ELECTRIC)	
11	10	40011153	SCREW, (M8 x 45)	3	(ELECTRIC)	
11	10	40011149	SCREW, (M8 x 25)	1	(MANUAL)	
12	10	826844 30	SCREW, (M6 x 30)	2	(ELECTRIC)	
12	10	824832 4	SCREW, (M6 x 16)	1	(MANUAL)	
13	54	65292	J CLIP	1	(ELECTRIC)	
14	87	828040F	PRESSURE SWITCH	1		5
15		828358	SENSOR	1		
16	10	40011107	SCREW, (M5 x 16)	2		
17	10	821300 25	SCREW, (M6 x 25)	3		
18	12	65567	WASHER, (.265 x .750 x .048)	3		
19		859224	PLATE	1		
20	23	822003	BUSHING	3		
21	25	834985	GROMMET	3		
22		856178T 3	ECM	1		
23	23	853920 1	BUSHING	3		
24	10	821291 40	SCREW, (M6 x 40)	3		
25	33	827858	SPARK PLUG, (NGK-DPR6EA-9)	3		
26		NSS	NOT SOLD SEPARATE, Decal-Coi	1		
27	339	830404T 3	IGNITION COIL	3		
28	10	40011128	SCREW, (M6 x 20)	3		
29	84	856158A 2	ENGINE WIRING HARNESS	1	(MANUAL)	
29	84	854781A 2	ENGINE WIRING HARNESS	1	(ELECTRIC)	
30	88	812619	FUSE, Yellow (20 Ampere)	1	(ELECTRIC)	
31		828054	COVER, Fuse	1	(ELECTRIC)	
32		826115 1	CLAMP, Connector	1	(ELECTRIC)	
33	10	824832 4	SCREW, (M6 x 16)	2	(ELECTRIC)	
34	84	852375A 6	EXTENSION HARNESS	1	(ELECTRIC HANDLE)	
35	54	816311T	CABLE TIE, (8.00 Inches)	AR		
36	54	47483	J CLIP	1	(MANUAL)	
37		854514T	VOLTAGE REGULATOR	1	(ELECTRIC)	
38	54	65292	J CLIP	1	(ELECTRIC)	